

CONFIDENTIAL

INDEX	ITEM NO.	ED	AMENDMENT	DATE	SIGN

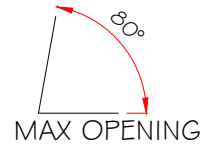

35.5mm SEALED GLAZED UNIT (1.5W/m²K)
6mm TOUGHENED K PAR EDGES,
20mm ARGON FILLED CAVITY,
9.5mm TOUGHENED LAMINATE

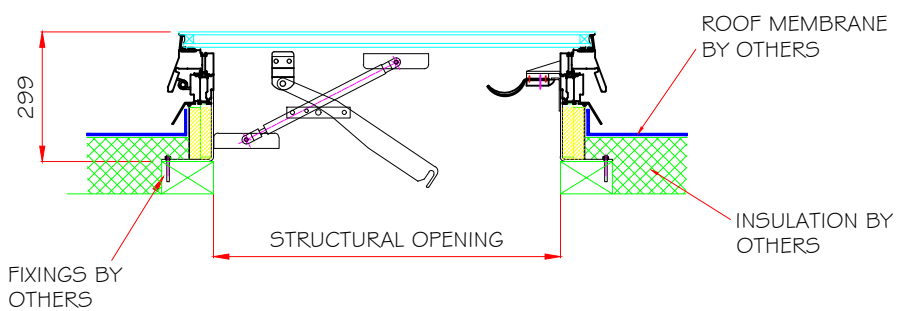
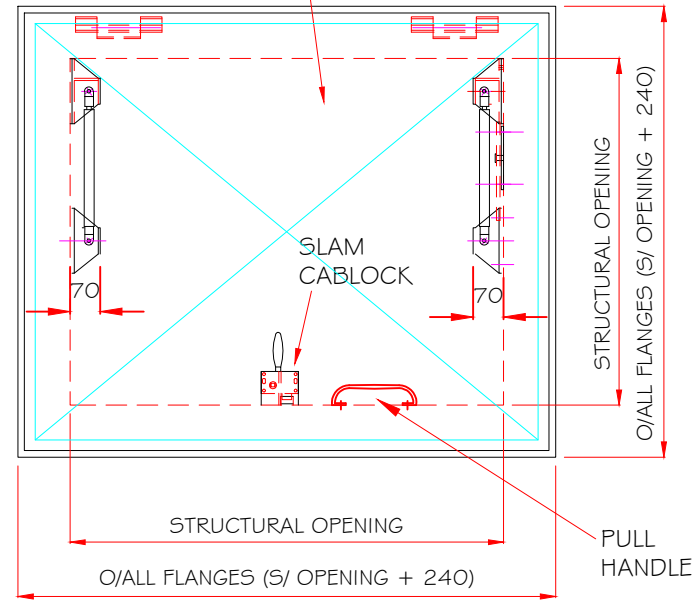
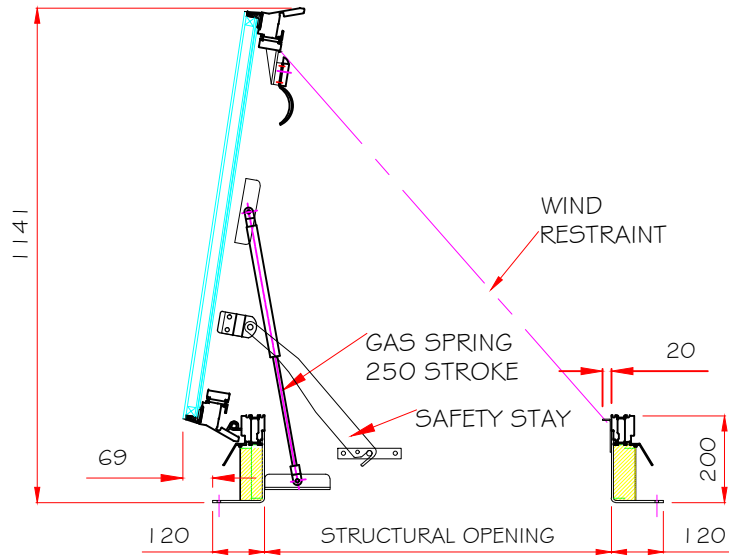

SRHG LO1
MATERIAL - ALUMINIUM
FINISH: SELF COLOUR
1 No. REQD

THE INTERFACE OF THIS ACCESS HATCH WITH THE ROOFING STRUCTURE, WEATHERING AND WITH ANY OTHER RELATED INTERFACE SUCH AS LADDERS, STAIRWAYS ETC IS OUTSIDE THE RESPONSIBILITY OF SURESPAN. IF IN DOUBT PLEASE SEEK CLARIFICATIONS

ALL HATCHES SHOULD BE FIXED TO A FLAT SURFACE WITH A RECOMMENDED 5° PITCH

WIND RESTRAINTS SHOULD BE SPECIFIED ON ALL ACCESS HATCHES SUBJECT TO HIGH WIND CONDITIONS

THIS IS A MANUALLY OPERATED ACCESS HATCH/COVER AND IT IS ESSENTIAL THAT SAFE MEANS OF ACCESS IS PROVIDED FOR THE OPERATOR

Copyright is claimed in this drawing and no copy may be made without prior written permission	The article shown is also the subject of	
	patent rights	✓
	registered design right	✓
	unregistered rights	✓
	The drawing is a design document	✓
	patent pending	✓

ITEM NO.	NO OFF	DRG NO.	ITEM MASS	DENOMINATION	MATERIAL	REMARKS
				SRHG - GAS SPRING		
				GA		
Existing law protects SURESPAN'S right of possession to this drawing. The design or the drawing must not, without permission of the company, be published, copied, reproduced, manufactured or exploited in any other unauthorized way.						
				DRAWN BY	MJ	
				DATE	24/03/17	
CONTRACT NO.				DRAWING NO.		REV No
					SRHG-GS-1	A

DRAWING MADE BY CAD
MANUAL CHANGES PROHIBITED